

9F44

Traverse en acier, entre-axes 110 mm, avec raccord en laiton prise de pression, taraudée EN 10226-1, avec support mural.

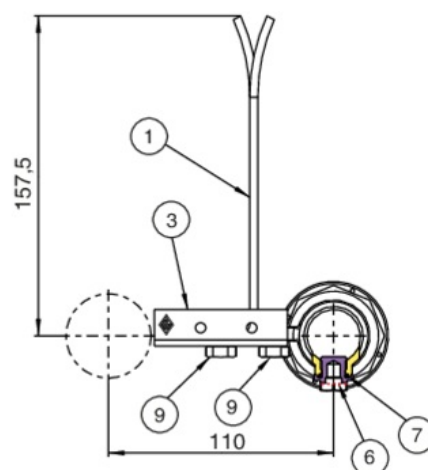

Spécifications techniques

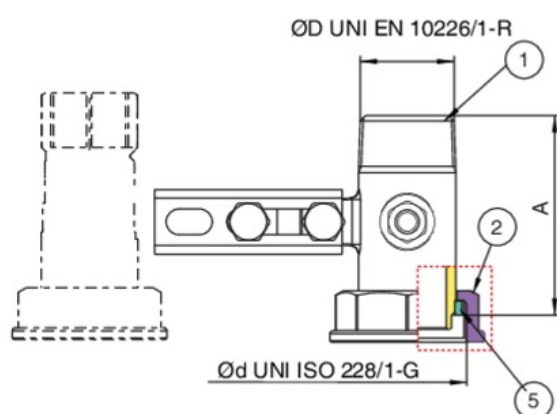

| ØD X ØD | DN | BOX | MASTER BOX | CODE | A |
|------------|----|-----|------------|------------|------|
| 1" x 1"1/4 | - | - | 25 | 9F44290000 | 69,5 |

Applications

